

105克双铜
骑马钉装订
成品尺寸10*7cm

Wireless Home Monitor

User Manual

Version: V0.4

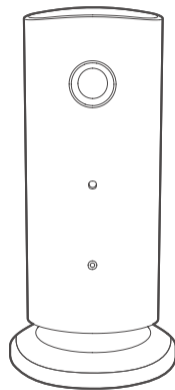

Prior to use, please read this manual thoroughly to ensure fast and effective installation. Final appearance, color and accessories are subject to change without notice.

1 Accessories

Check the product and accessories as below to see if they are complete, otherwise please contact your local supplier.



Camera body



Wall mount (Optional)



Magnetic base

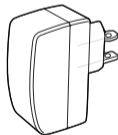

Charger

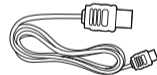

Power cable



Setscrew×3 (Optional)
Screw×3 (Optional)

2 Specifications

CPU	32bit RISC SoC processor
Image sensor	1/4" color CMOS sensor
Image resolution	HD 720P(1280*720), WVGA(854*480)
Camera lens	Aperture F2.8, 127° wide angle
Video compression format	H.264
Video bitrate	Dynamic VBR 32Kbps-2Mbps
FPS	Max 25fps
Audio working mode	Voice talk and monitor
Audio format	G.711 (16bit/8KHz)
Network interface	WiFi (IEEE802.11b/g/n)
Connection way	P2P, WLAN RELAY
Focus mode	Fixed
Focus range	0.4m to infinity

Memory	TF Card (Max 32G) local storage and Dropbox service
Video format	AVI
Working status indicator	Bi-color LED indicator light
Photo capture	Support
Motion/Noise detection	Support alarm message pushing
Mobile terminal	Support iOS/Android system
Working environment	-10°C~50°C, humidity<95%
Upgrade way	Firmware OTA remote upgrade
Security setting	128bit AES password
Power consumption	<5W
Power input	5V/1A, USB interface
Dimensions	50(L)×50(W)×98(H)mm (with base) 40(L)×36(W)×89(H)mm (without base)

3 Structure

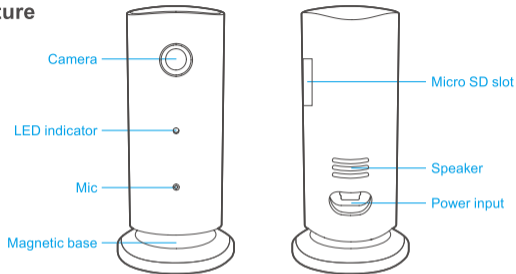

3.2 LED indicator status

Status	Meaning
Blue led constantly on	AP setting mode
Blue led flash slowly	Wi-Fi working
Blue led flash slowly + Red led flash once	Wi-Fi working +recording
Blue led flash slowly +Red led flash twice	Wi-Fi working +video is being watched
Blue led flash slowly +Red led flash once +Red flash twice	Wi-Fi working +recording +video is being watched

4 Operation

4.1 Connect with power

1. Connect with the power cable and charger
2. The Blue LED indicator will be flashing slowly if the device is connected successfully with the WIFI network. If the Blue LED is constant on, it means the WIFI network is not set correctly or there is no WIFI, and it will enter into AP setting mode. (NOTE: AP means Access Point, also known as “Hot Spot”, in this mode, the phone connects with the Camera directly without Ethernet connection.)

4.2 Fast setting

4.2.1 APP

Please download APP “Jimilivepro” from APP store or at Google Play.

4.2.2 WIFI setting

- 1)When device blue LED is constant on, please go to your phone’s wifi setting and connect to an available network.
- 2)Start APP on your phone,create account and login.

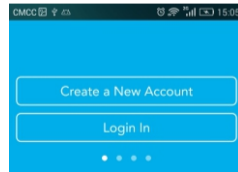

A) Create Account

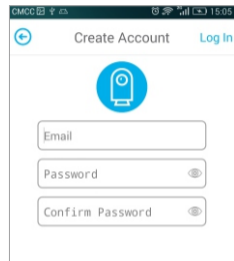

B) Log In

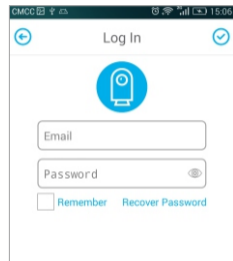

C) Recover password

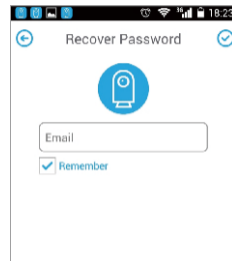

D) Email Validate

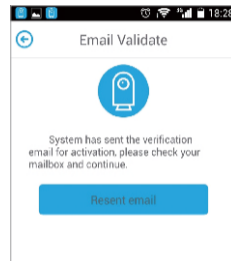

NOTE: For iOS device, after successful login, press home button and go to the phone's wifi setting, find the connection name "JH08_XXXXXX" and input password "88888888". After that, please go back to the APP.

3) Enter "Home" page. A dialog will prompt, indicating necessary version upgrade. Click "OK" to start update. Click "cancel" to remove the dialog that will appear twice daily.

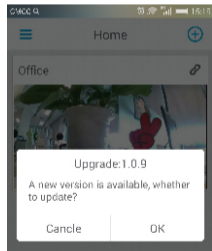

9

Click  to add camera.

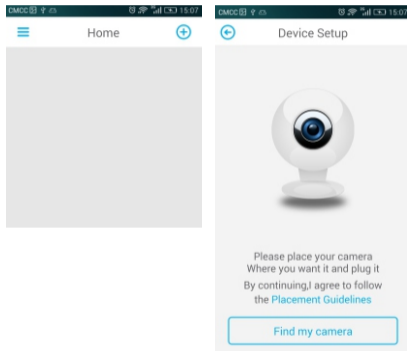

4) Select an available WIFI network and confirm by clicking 

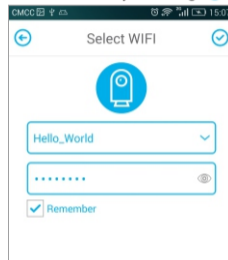

Select your camera and start setup.

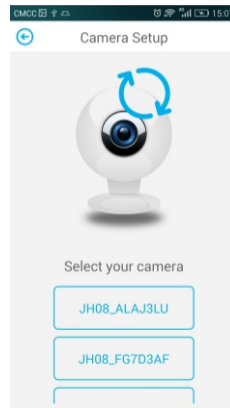

10

5) Personalize the environment of the camera

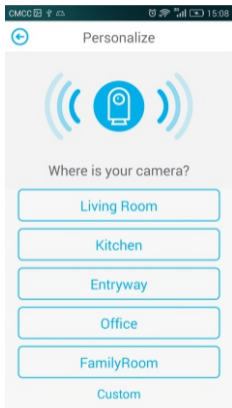





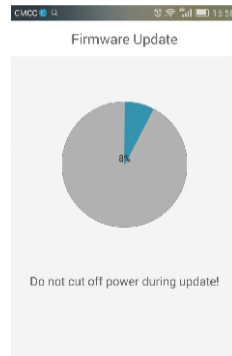
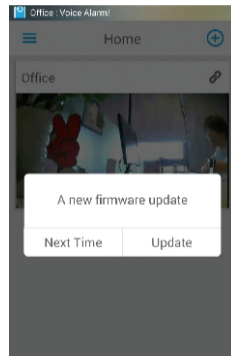
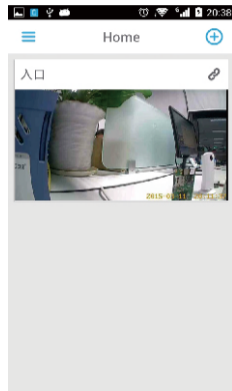

11

6) Click camera to enter Live-monitor page; Check the camera firmware; A dialog will prompt if there is necessary firmware update. Click "next time" to remove the dialog that will appear twice daily. Click "update" to start the process.



12

7) Click camera to enter Live-monitor;
 Press "Hold to Talk" to talk to the camera;
 Click  to turn ON/OFF voice monitor;
 Click  to take a snapshot;
 Click  to take video manually;
 Click  to check alerting report, video and snapshot;
 Click  to share the camera to another account.
 Double click the screen or click  to switch screen orientation.

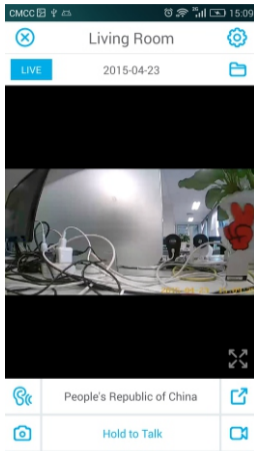
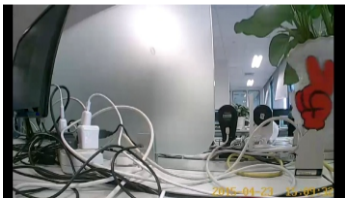

8) Press and hold the screen to unbind the target camera. Unbinding the camera will ask for account and password information and restore to AP mode (direct connection between the phone and the camera, no ethernet) again. (NOTE: One device UUID can only connect with one email account, if this device UUID is already bound to an email account, it needs to be unbound manually so that it could be bound to another email account again. Unbind the camera will restore to factory setting and restart camera, to bind the camera again needs to place your phone near to the camera.)

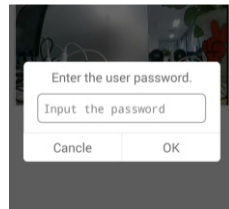
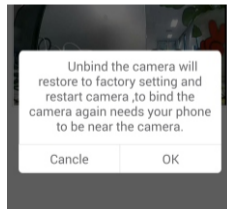

9)Click ☰ at front page to enter the layout page.
“Account” “Share” and “About” information could be checked here.

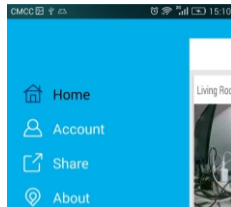

A)Account: Log out, change password and choose network model (Wifi-Only : Live-monitor and Playback only with available WIFI, Always : Live-monitor and Playback with WIFI or mobile network; Never : Live-monitor and Playback is never allowed.)

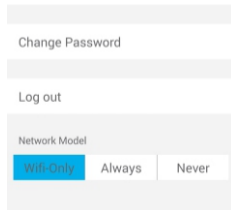

B)Change password

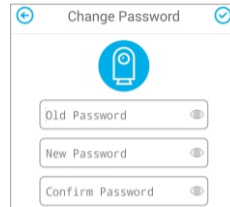

C)About: Version check and update for APP

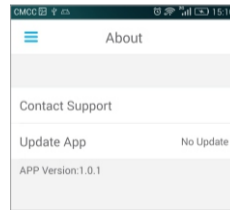

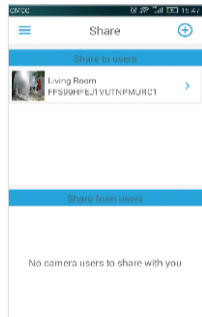

D)Share. User can share his camera-monitoring page to other users, vise versa.

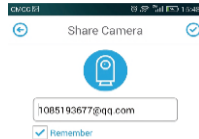
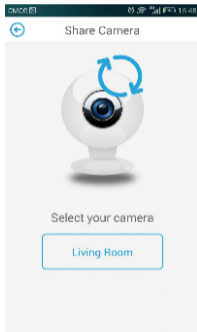
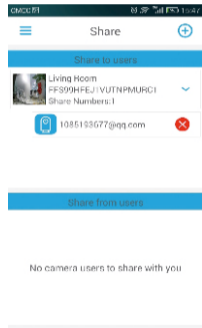

17

Click "Share to users" and "Share from users" to check the details



10)Click  on Live-monitor page to access Album, Alarms and Fulltime video. Album includes snapshot and manual video. Alarms includes motion detection alarm and voice detection alarm. Click the video to playback.

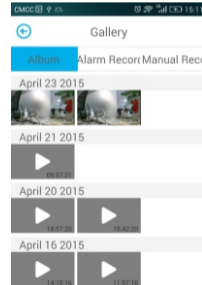

18

11) Click  on the Live page to enter Setting page.

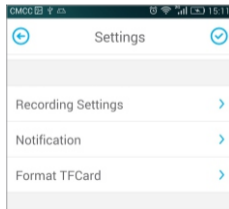

A) Camera setting

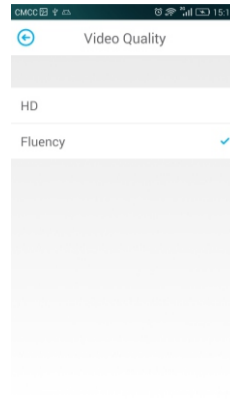
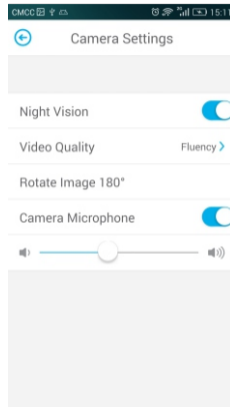

B)WIFI setting

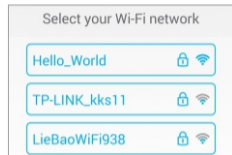

C)Camera Reboot

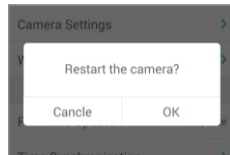

D)Alert settings

When the camera detects motion or sound, sends alert message to the APPs. Alert activate schedule can be set.

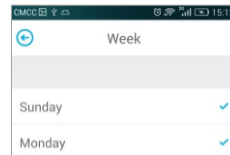
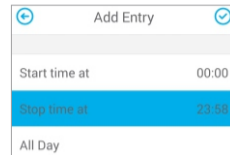
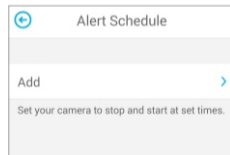
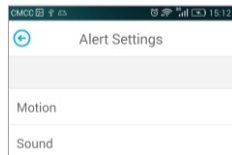

E)Notification Mode (Push notification: Alarm notification would be pushed to the mobile phone)

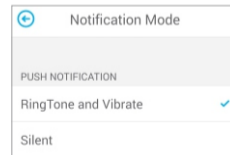

F)Recording settings

Off: No recording

Alarm recording: Alarm setting and schedule could be checked in Gallery page

Manual recording: When you choose manual recording, the camera starts recording for 5 minutes then turn back to Off recording status.

Full-time recording: When you choose full-time recording, the camera starts recording for 30 minutes.

(Note: If the camera supports Night-Vision function, Manual recording will display, or you will see Full-time recording)

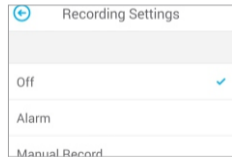

G)DROPBOX Settings(ANDROID ONLY): DropBox identification means DropBox would ask for a temporary code to enable your upload. Prior the setting please create an account on DropBox official web, which enables you to upload alarm picture and video to Dropbox cloud storage.

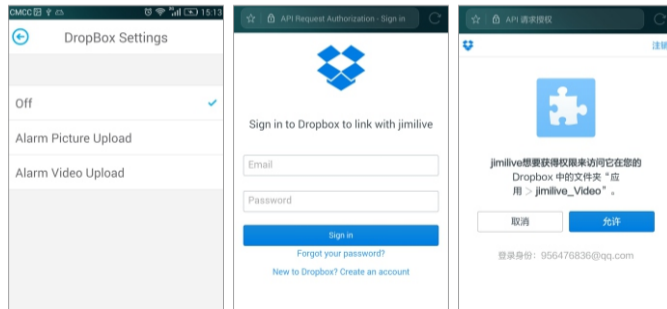

H)Format TFCard (Choose Format TF Card in Settings page)

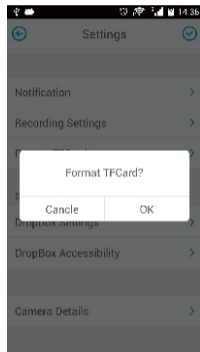

25

I)Camera details

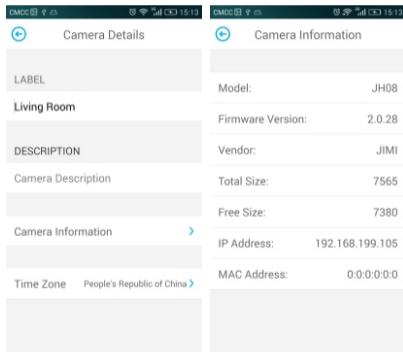

J)Timezone setting

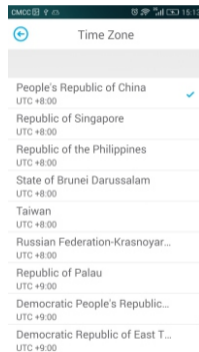

K)Get device password: Enter user password first to check device password.

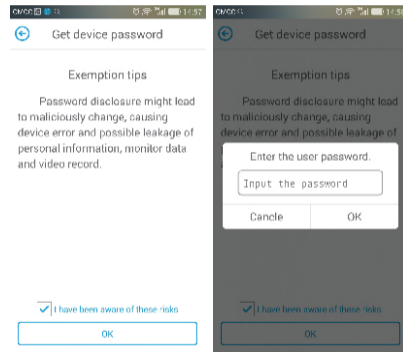

26

5 Installation

you can put the device on a flat surface with the magnetic base or install it on the wall or the ceiling. Details please check below:

- ⚠ Notice:** a. Before installation, please make sure the device is close to the power socket.
b. Before secure the pin and the screw, please drill holes on flat and solid surface.

5.1 Wall mount installation

5.1.1 Remove the pin from wall mount

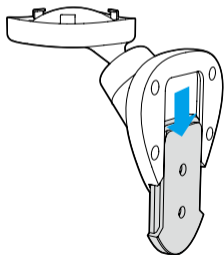

5.1.2 Drill holes

Drills holes on the wall according to the position of the pin holes.

5.1.3 Secure the pin to the wall

Place two setscrews into the holes, then secure the pin to the wall with the two screws.

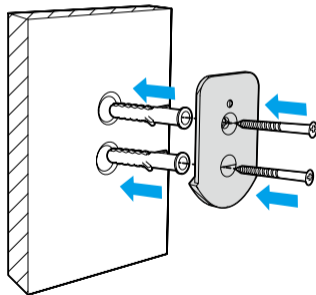

5.1.4 Secure the device on the wall mount.

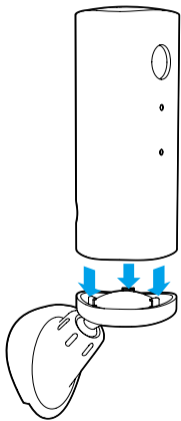

5.1.5 Secure the wall mount to the pin.

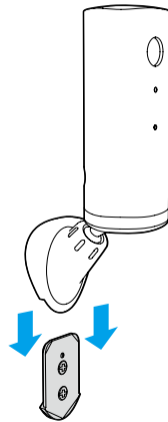

5.2 Ceiling installation

 **Notice:** Please set "Video flip" in the APP's "Camera setting" if install on the ceiling, otherwise the image will be back side down.

5.2.1 Use a slot type screwdriver to take out the top cover gently and reveal the screw hole.

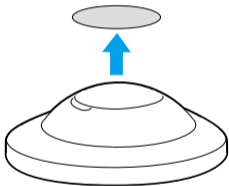

5.2.2 Drill holes on the ceiling according to position of the magnetic base.

5.2.3 Secure the magnetic base onto the ceiling

Use one setscrew and one screw to secure the magnetic base to the ceiling.

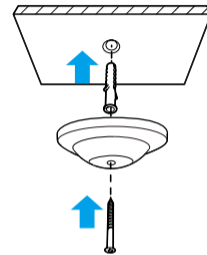

5.2.4 Press back the circle top cover.

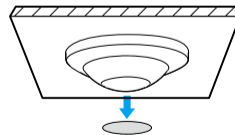

5.2.5 Place the device onto the magnetic base, and then adjust the angle to a proper position.

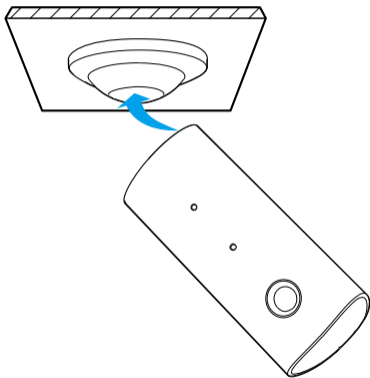

6 Trouble shooting

During operating if encounter any problems, please read the following table, contact your local supplier if the problem remain unsolved.

Common errors	Possible Causes	Solutions
Connection failed	Device not in WIFI	Confirm the device is connected to WIFI successfully
	WIFI network error	Check WIFI status
	Phone network error	Make sure your phone can access internet
Cannot receive motion detect alarm messages	Motion detect not activated	Activate motion detect function
	Not login to APP	Make sure the APP is running or running in backstage
Micro SD error	No SD card	Insert SD card
	Micro SD card fail	Replace or format the card
Live view black screen or replay failure	Bad network connection of cellphone	Improve network condition